

**TEMPLATE
FOR
INSTALLING
#480 LINE
CYLINDER
DEADLOCKS**

SARGENT
ASSA ABLOY

ASSA ABLOY, the global leader
in door opening solutions

SEE BACK FOR DIRECTIONS

Copyright © 2008 SARGENT Manufacturing. All rights reserved.
Reproduction in whole or in part without the express written
permission of SARGENT Manufacturing is prohibited.

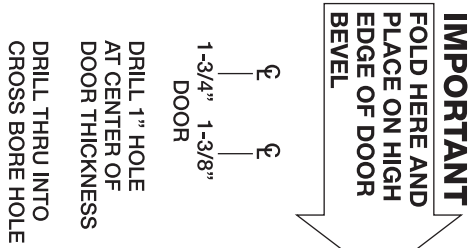

**TEMPLATE
FOR
INSTALLING
#480 LINE
CYLINDER
DEADLOCKS**

SARGENT
ASSA ABLOY

ASSA ABLOY, the global leader
in door opening solutions

SEE BACK FOR DIRECTIONS

Copyright © 2008 SARGENT Manufacturing. All rights reserved.
Reproduction in whole or in part without the express written
permission of SARGENT Manufacturing is prohibited.

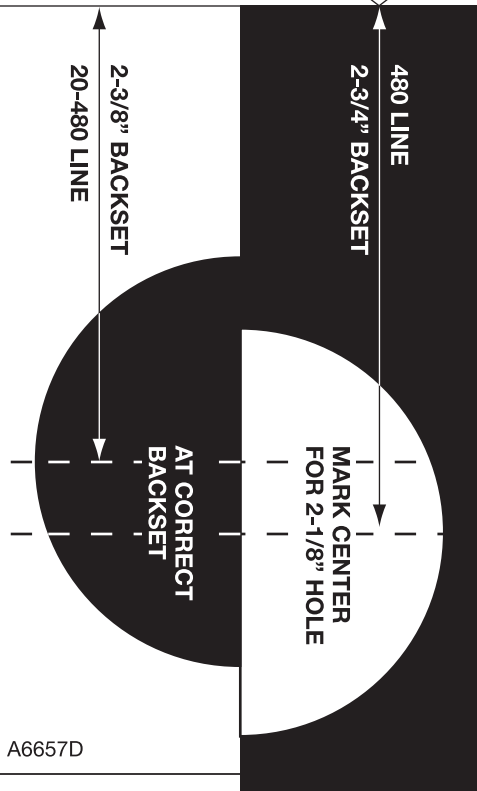
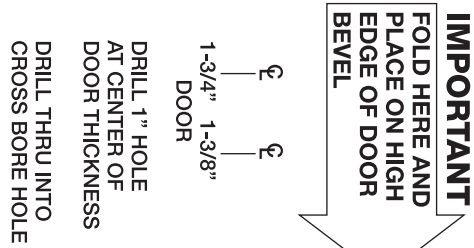

A6657D

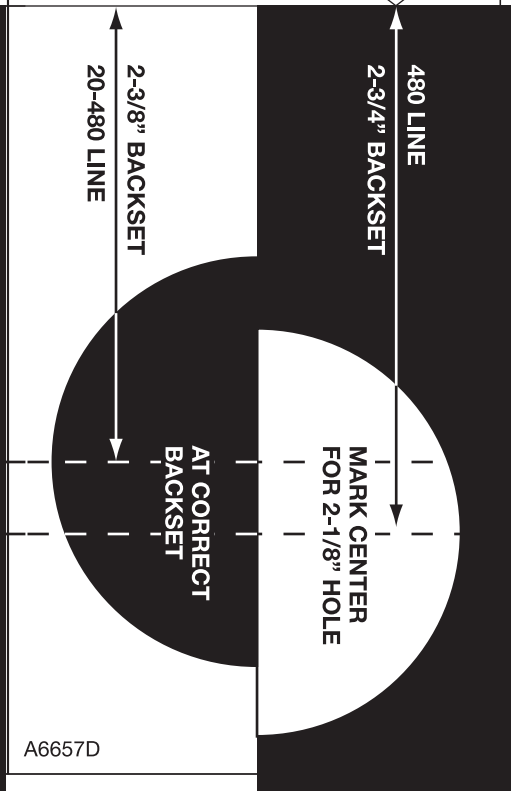

A6657D

TO MORTISE DOOR FOR LOCK

1 DETERMINE CORRECT BACKSET FROM BOX LABEL (OR BY MEASURING). PLACE TEMPLATE ON DOOR, AS SHOWN, AND MARK FOR HOLES.

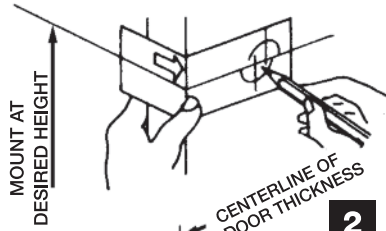

2 BORE 2-1/8" HOLE THRU DOOR.

3 DRILL 1" DIA. HOLE INTO FIRST HOLE.

4 CUT OUT FOR LOCK FRONT

TO MORTISE DOOR FOR LOCK

1 DETERMINE CORRECT BACKSET FROM BOX LABEL (OR BY MEASURING). PLACE TEMPLATE ON DOOR, AS SHOWN, AND MARK FOR HOLES.

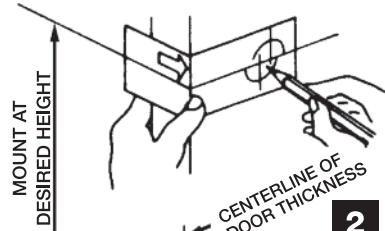

2 BORE 2-1/8" HOLE THRU DOOR.

3 DRILL 1" DIA. HOLE INTO FIRST HOLE.

4 CUT OUT FOR LOCK FRONT

TO MORTISE FRAME FOR STRIKE

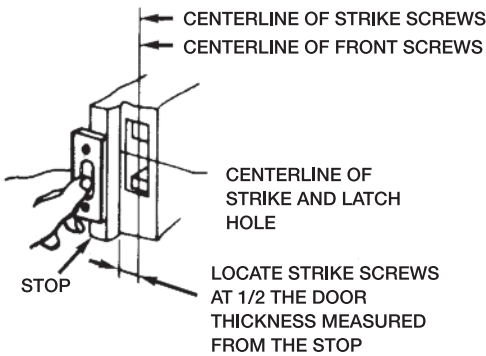

TO MORTISE FRAME FOR STRIKE

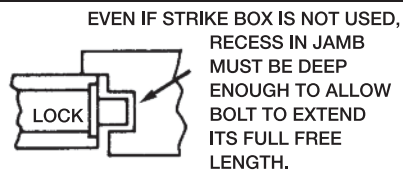
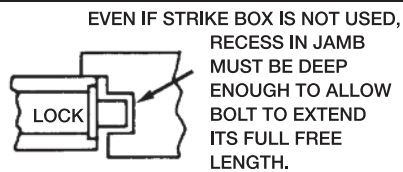
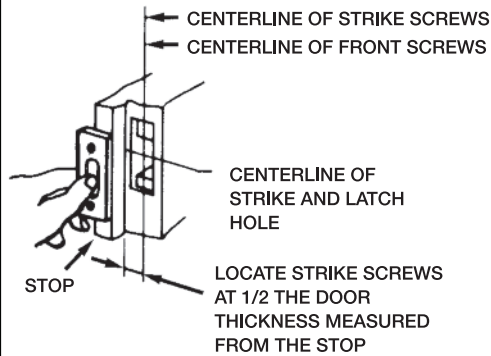

A6657D **SEE REVERSE SIDE**

A6657D **SEE REVERSE SIDE**